

# STOP FITTINGS



## Product Code System

METRIC - BSPT(R)  
**SPC 06-01**

STOP FITTING	TUBE DIA		THREAD SIZE	
	CODE	ØD	CODE	SIZE
	04	Ø4	M5	M5×0.8
	06	Ø6	M6	M6×1.0
	08	Ø8	01	R 1/8
	10	Ø10	02	R 1/4
	12	Ø12	03	R 3/8
			04	R 1/2

METRIC - BSPP(G)  
**SPC 06-G01**

STOP FITTING	TUBE DIA		THREAD SIZE	
	CODE	ØD	CODE	SIZE
	04	Ø4	G01	G 1/8
	06	Ø6	G02	G 1/4
	08	Ø8	G03	G 3/8
	10	Ø10	G04	G 1/2
	12	Ø12		

INCH - NPT  
**SPC 1/4-N1**

STOP FITTING	TUBE DIA		THREAD SIZE	
	CODE	SIZE	CODE	SIZE
	5/32	Ø 5/32	U	10-32UNF
	3/16	Ø 3/16	N1	NPT 1/8
	1/4	Ø 1/4	N2	NPT 1/4
	5/16	Ø 5/16	N3	NPT 3/8
	3/8	Ø 3/8	N4	NPT 1/2
	1/2	Ø 1/2		

## Uses

- Used often where pneumatic piping is changed frequently

## Features

- When the tube is removed, the air is completely blocked. When connected again, the air is to flow for the purpose of ensuring good maintenance or safety of the device.
- With the stop fitting installed, compressed air is supplied only when the tube is connected

## Specifications

Applicable fluid	compressed air (Not applicable to gases or liquids)
Operating pressure	0~150PSI / 0~9.9kgf/cm <sup>2</sup> (0~990kPa) ※ The combination with the applied tube shall be decided based on the maximum operating pressure of the tube.
Negative pressure	-29.5 in Hg / -750mmHg(-750Torr)
Operating temperature range	32~140° F / 0~60°C
Hose materials used	polyurethane, nylon

## Structural drawing

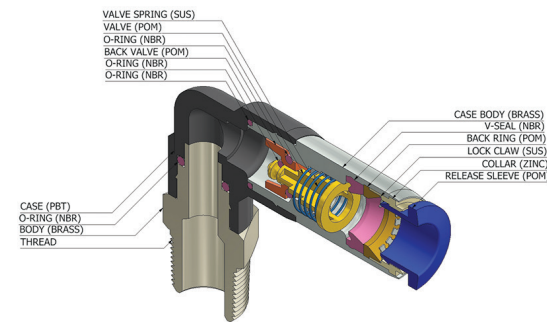

## Example of uses

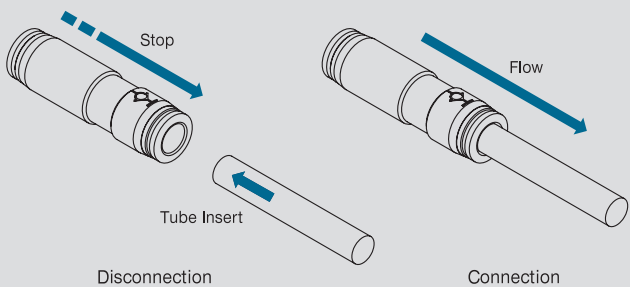

## CAUTIONS

- Be sure to note safety precautions, the classification method of warning signs (p.25), and the common precautions for fitting products (p.24) before using them.
- Assemble with reference to proper fastening torque for fitting. (p.26)
- Fasten by hand and rotate 2-3 turns with a tool. Be careful that fastening too hard may damage the screw thread.
- When the tube is installed, check the direction of the air flow before using it.  
If assembled in the opposite direction to air flow, air does not flow. Check the direction of air flow before piping and assembling

## WARNINGS

- Do not impact on or forcibly rotate the body or fitting.
- Do not open the tube with pressure applied when opening the tube. The bouncing force of the tube under pressure can cause damage to the human body. Please be careful when using it.

SPC

Straight

SPC-G

Straight

MODEL(φD-T)					
Tube <b>Metric</b> -Thread <b>R</b>		Tube <b>Inch</b> -Thread <b>NPT</b>		Tube <b>Metric</b> -Thread <b>G</b>	
SPC 04-01	SPC 10-03	SPC 5/32 -N01	SPC 5/16 -N03	SPC 04-G01	SPC 10-G03
SPC 06-01	SPC 10-04	SPC 3/16 -N01	SPC 3/8 -N02	SPC 06-G01	SPC 10-G04
SPC 06-02	SPC 12-02	SPC 3/16 -N02	SPC 3/8 -N03	SPC 06-G02	SPC 12-G02
SPC 08-02	SPC 12-03	SPC 1/4 - N01	SPC 3/8 -N04	SPC 08-G02	SPC 12-G03
SPC 08-03	SPC 12-04	SPC 1/4 - N02	SPC 1/2 -N03	SPC 08-G03	SPC 12-G04
SPC 10-02		SPC 5/16 - N01	SPC 1/2 -N04	SPC 10-G02	
		SPC 5/16 - N02			

SPL

Elbow

SPL-G

Elbow

MODEL(φD-T)					
Tube <b>Metric</b> -Thread <b>R</b>		Tube <b>Inch</b> -Thread <b>NPT</b>		Tube <b>Metric</b> -Thread <b>G</b>	
SPL 04-M5	SPL 08-02	SPL 5/32 -U	SPL 5/16 -N01	SPL 04-G01	SPL 10-G04
SPL 04-M6	SPL 08-03	SPL 5/32 -N01	SPL 5/16 -N02	SPL 06-G01	SPL 12-G03
SPL 04-01	SPL 10-02	SPL 3/16 -U	SPL 5/16 -N03	SPL 06-G02	SPL 12-G04
SPL 06-M5	SPL 10-03	SPL 3/16 -N01	SPL 3/8 -N02	SPL 08-G02	
SPL 06-01	SPL 10-04	SPL 3/16 -N02	SPL 3/8 -N03	SPL 08-G03	
SPL 06-02	SPL 12-03	SPL 1/4 -U	SPL 3/8 -N04	SPL 10-G02	
SPL 08-01	SPL 12-04	SPL 1/4 -N01	SPL 1/2 -N03	SPL 10-G03	
		SPL 1/4 -N02	SPL 1/2 -N04		

SPU

Union Straight

SPUM

MODEL(φD)		MODEL(φD)	
Tube <b>Metric</b>	Tube <b>Inch</b>	Tube <b>Metric</b>	
SPU 04	SPU 5/32	SPUM 04	
SPU 06	SPU 3/16	SPUM 06	
SPU 08	SPU 1/4	SPUM 08	
SPU 10	SPU 5/16	SPUM 10	
SPU 12	SPU 3/8	SPUM 12	
	SPU 1/2		

